

PRELIMINARY FOR REVIEW ONLY

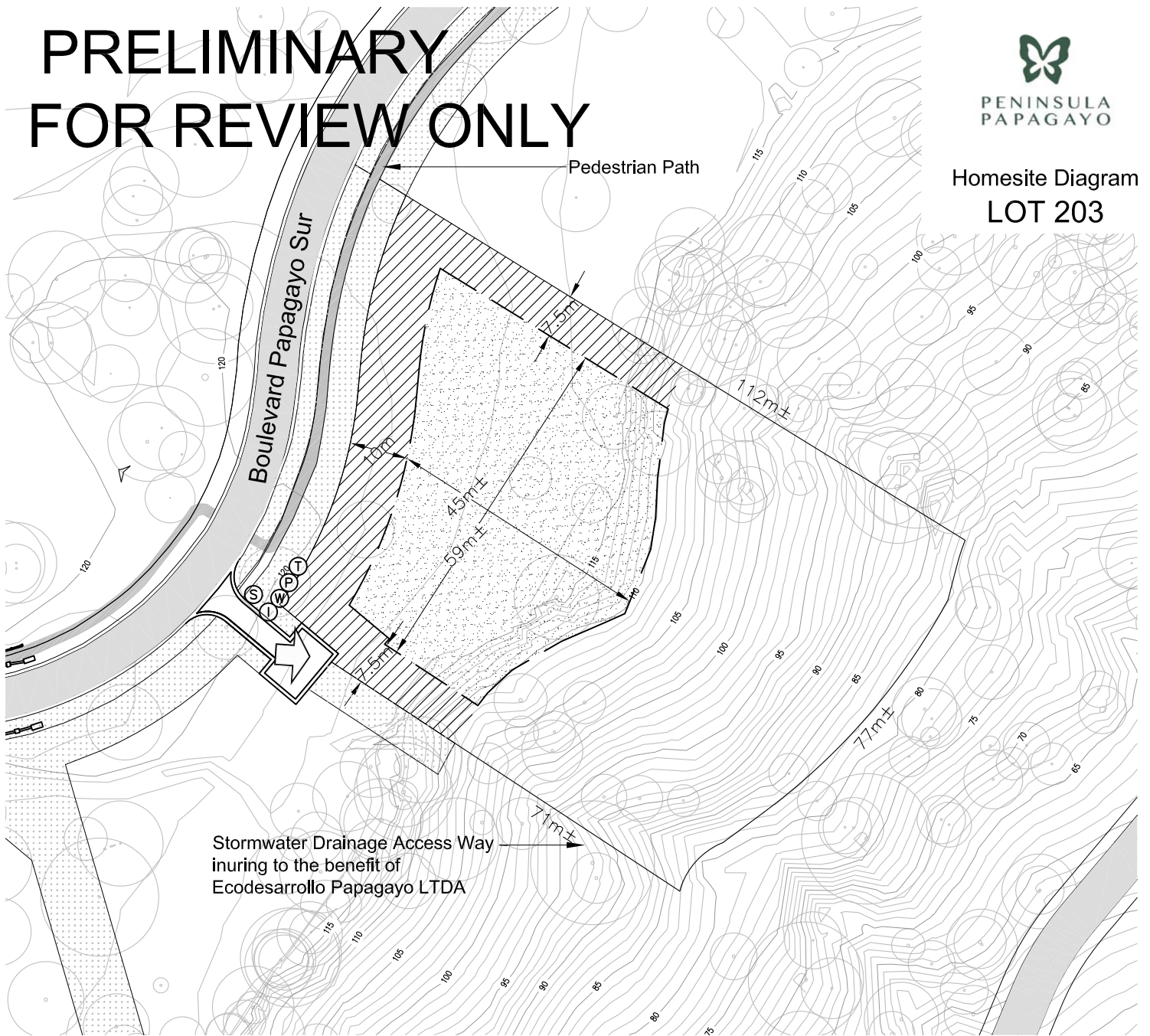

PENINSULA
PAPAGAYO

Homesite Diagram LOT 203



Approximate Lot Area: 7422.66 m² / 1.83 acres
 Approximate Building Envelope Area: 2415.86 m² / 0.60 acres

Lot Type: Mesa
 Maximum Building Height: 10 meters

Legend

- | | | | | | |
|--|----------------------------|--|--|--|-------------------------------------|
| | Contour lines 1.0m | | Contracuneta | | Existing utility box |
| | Lot boundary | | Top of road cut | | Hydrant |
| | Building Envelope Boundary | | Mojones / 50 meter setback from mean high tide | | Irrigation water line connection |
| | Building Envelope Area | | Landmark trees | | Potable water line connection |
| | Natural Area | | Existing trees | | Sewer line connection |
| | Setback / Transition Area | | Restricted trees* | | Telecommunication/signal connection |
| | Association Landscape Area | | | | Power connection |
| | Lot Access / Entry | | | | Petroglyph site |

* Restricted trees are protected by Costa Rican law and cannot be removed.

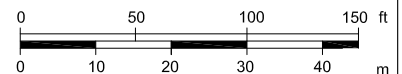
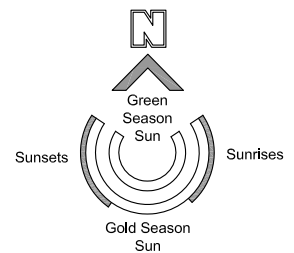

The primary purpose of the Homesite Diagram is to show the specific location of the Building Envelope, Transition Areas and Natural Areas in relationship to the property lines. All other information shown on the Homesite Diagram, including without limitation, topography, tree locations, drainage, and utilities (collectively, the "Additional Information") is intended to be general in nature. Therefore, Ecodesarrollo Papagayo LTDA makes no representation or warranty with respect to the accuracy of such Additional Information. It is the responsibility of the Lot purchaser/owner to verify all such information with a field survey. Lot purchasers/owners are required to conduct an independent topographical field survey for all designs as well as for all submittals to the Master Design Review Board. Ecodesarrollo Papagayo LTDA hereby disclaims any liability for itself or its agents with respect to the accuracy of the Additional Information.